

PALOMA
HOTELS

GRID A

Summer 2025
Fact Sheet

GENERAL INFORMATION

Official Category : 5 Star
Catalogue Category : 5 Star
Concept : Luxury Ultra All Inclusive
Year of Renewed :2025
Total Number of Rooms : 529 (Main building and 25 blocks)
Credit card: Visa, Master Card, America Express



LOCATION

Directly on the Beach
700 m to Belek
35 km to Antalya Airport,
45 km to Antalya City
Next to the Golf Courses

CONTACT INFORMATION

İskele Mevkii TR-07500 Belek-Antalya
P: +90 242 715 15 00 | info@palomahotels.com | palomahotels.com

Our operation, such as meals and services, are adjusted according to the international and local rules and guidelines. Changes to hotel information, facilities, activities and services can occur for a variety of reasons. Paloma Hotels reserves the right to make changes without prior notice.

OUTSTANDING IMPLIMENTATION

of Paloma Hotels
NEW AGE
FOOD & BEVERAGE
CONCEPT

Experience a fresh & modern
approach to dining, featuring
organic products harvested
straight from our own farm.





DIVERSE DINING OPTIONS;

Enjoy a selection of four à la carte restaurants, each offering a unique culinary experience

wabi sabi

CURIO

Quentine

avare
Kebab & Meze



ALL – IN FOOD

Breakfast, lunch, and dinner in the main restaurant buffet with a seasonal organic food corner and fresh orange juice at breakfast.

Ice cream served daily during lunch and dinner in the main restaurant.

Bistro: Serving all day, fresh sandwiches, ice cream, pastries, cookies with coffee & tea.

Late breakfast at Bistro 10:00 - 11:00

Snack service at Bistro 15:00 - 18:00

Late Snack at Bistro 23:00 - 07:00

Snack service at Quentine 12:00 – 15:00

24 hr Room Service with an extra charge. Orders can be made through Paloma Hotels App.

***À la Carte Restaurants: Reservation is required through the Paloma Hotels App or Guest Relations.

Wabi Sabi - Fusion Far East (free of charge)

Quentine - Contemporary Mediterranean (free of charge)

Avare - Traditional Turkish Kebab (free of charge)

Curio - BBQ (with an extra charge)

Beach & Pool Concept: Summer coolers, fruits, and small snacks are served to sunbeds at the beach and pool area at certain times.

Kids' Chef: Our Kids' Chef combines fresh and healthy ingredients with entertainment to create nutritious and fun meals for our little guests.

*** Our a'la carte restaurant is open six days a week.





BEVERAGE CONCEPT

Welcome drink on arrival
Selected import and local spirits, Organic Wine selections served in Bars & Restaurants

- 7 Bars**
- Bistro Bar (24hr)**
- Pool Bar**
- Beach Bar**
- Quentine Bar**
- Zomm Bar**
- Adults Only Lounge**
- Aqua Bar**

Mini bar, replenished daily in once with water, soft drinks & beer
Kettle coffee & tea service is available in all rooms

**Alcoholic beverages are not served to guests under the age of 18.



BEACH & POOLS

Hotel owns Sandy Beach – 235 mt

11 Pools: 9 Outdoor Pools & 2 Indoor pools

Relax Pool: 1335 m3 - from 135 cm to 140 cm deep

Activity Pool: 1136 m3 - from 135 cm to 140 cm deep

Middle Pool : 635 m3 140 cm deep

Children's Pools: 72 m3 from 30 cm to 40 cm deep

Lake Villa Pool: 775 m3 –from 135 cm to 140 cm deep

Lagoon 1 Pool: 494 m3 140 cm deep

Lagoon 2 Pool: 685 m3 140 cm deep

Indoor Pool: 140 cm deep (closed 01.05 - 30.09)

Indoor Children's Pool: 12 m3 – 40 cm deep

Aquapark Area

Aqua Park Pool : 160m3 – 120 cm

Aqua Tower Pool: 300m3 – 25-30 cm deep

Pool and Aquapark Regulations, determined according to international standards, are available through the QR information system located in the rooms at our hotels.

- Towels, sunbeds, and sunshades are provided free of charge.

An aerial view of a water park. On the left, a large structure with a brown roof has several slides leading down to a pool. The slides are numbered 1 through 5. In the center, there is a pool with a slide leading into it, numbered 6. To the right, there is a playground area with a slide, numbered 7. The park is surrounded by lush green trees and a paved walkway.

SLIDES

1. Blackhole
2. Windigo
3. Aquatube
4. Flying Saw
5. Riftslide

KIDS PLAYGROUNDS & ENTERTAINMENT

6. Aquatower for Kids
7. Spray Action

ENTERTAINMENT & MINI CLUB & SPORT FACILITIES

Palomotion welcomes you with a generous array of family-friendly activities and curated experiences. Have the time of your life at Paloma Hotels.

Daily Sport Activities: Beach volleyball, basketball, tennis, table tennis, mini football, mini golf, water polo, yoga, stretching, fit dance, Pilates, step, aerobics, gymnastics, total body, Tabata, water gymnastics, boccia, backgammon, card games, darts, billiards.

Tennis: 1 tennis court (quartz) and 1 padel court.

Fitness Center: 07:00 – 19:00

Polly Kids Club: 10:00 – 22:00, for ages 4-12

Kid's welcome package

Kids' animation

Children's playground

Mini disco

Daily activities (Ages 0-3 must be under the supervision of parents)

Teenage Club: For ages 13-16

Entertainment: Live music bands, animation shows, live shows, night Club

VACATION INTO UNLIMITED FUN!



Lagoon

Family Friendly Concept



Lagoon
Club House



Kids Club
Corner for
Lagoon



Unique
Family Friendly
Comfort



Private
Pool & Bar



Daily Pop-up
Treats



Concierge
Service



ACCOMMODATION PACKAGES

LAGOON Family Friendly Concept - additionally

Concierge Service 08:00 – 24:00

Club house service (fresh sandwiches, pastries, cookies with coffee & tea) (10:00 – 22:00)

Lagoon Private Pool & Bar

Local and exotic fruits and organic bottle of wine on arrival

Turndown service

Priority reservations for A'la Carte Restaurants

Lake Suite

Adult-Only Concept



Privileges
Exclusive for
Lake Suites



Direct Pool
Access



Private Spacious
Sunbating Spaces



Lake Special
Room Breakfast



Treat Yourself
Daily Service



Lake Club



ACCOMMODATION PACKAGES

Lake Suite Adult Only Concept - additionally

Private Pool & All Lake Suites with Direct Pool Access

Welcome bar setup on arrival (free of charge on the day of entry; additional requests are subject to a charge)

Fresh fruits, fresh flowers, and an organic bottle of Paloma wine on arrival

Breakfast, lunch, and dinner at the Lake Restaurant with reservation

Turndown service

Massage service to rooms upon request (extra charge applies)

Priority reservations for à la carte restaurants



ACCOMMODATION PACKAGES

Family Comfort Package – All Room Type (exp.Lake suites)

Available in Family Rooms & Lagoon Rooms upon request.

Baby & Toddler Package (0-4): Bottle warmer, baby bath, baby cot, baby phone, bottle sterilized and baby carriage are available on request (with deposit)

Kids' Welcome package: Activity Bag with toys, coloring book, crayons.

ACCOMMODATION

Room Type	Description	No of Bathroom s	m2	Total Number	max occupancy	Type of Bed	
						Dbl	Twin
Standard Main Building	Standard Room Land View with a double or twin bed + 1 daybed + balcony	1	24	220	2+1 / 3	1	
Standard Bungalow	Standard Room Garden View with a double bed + 2 daybeds + balcony	1	27	89	2+1 / 2+2 / 3	1	
Superior Standard LV	Superior Standard Room Land View with 1 double bed + 1 single bed + 1 daybed + balcony	1	40	52	2+1 / 2+2 / 3 / 3+1	1	1
Superior Standard SV	Superior Standard Room Sea View with 1 double bed + 1 single bed + 1 daybed + balcony	1	40	24	2+1 / 2+2 / 3 / 3+1	1	1
Family Suite Garden	Family Suite Garden View with 1 Bedroom + 1 livingroom + 2 daybeds + balcony	1	45	13	2+1 / 2+2 / 3 / 3+1	1	
Family Suite Main Building	Family Suite Land View with 1 Bedroom + 1 livingroom + 2 daybeds + balcony	2	50	34	2+1 / 2+2 / 3 / 3+1 / 4	1	
Terrace Suite	Terrace Suite Sea View with 1 Bedroom + 1 livingroom + 2 daybeds + large terrace	2	60	2	2+1 / 2+2 / 3 / 3+1	1	
Dublex Family Suite	Dublex Family Suite Garden View with 1 Bedroom + 1 livingroom + 2 daybeds + 1 sofa bed + balcony	2	55	26	2+1 / 2+2 / 2+3 / 3 / 3+1 / 3+2 / 4 / 4+1	1	
Lake Suite Direct Pool Access + 18 age	Lake Suite Direct Pool Access with 1 Bedroom + 1 livingroom with 1 daybed + Large terrace pool access, Adults only	1	50	17	2 & 3	1	
Lagoon Suite	Suite Upper floor Lagoon Pool View with 1 Bedroom + 1 livingroom + 2 daybeds + balcony	2	50	28	2+1 / 2+2 / 3 / 3+1 / 4	1	
Lagoon Suite Direct Pool Access	Suite Direct Pool Access with 1 Bedroom + 1 livingroom + 2 daybeds + Large terrace with pool access	2	50	11	2+1 / 2+2 / 3 / 3+1 / 4	1	
Lagoon Dublex Suite Direct Pool Access	Dublex Suite Direct Pool Access with 1 Bedroom + 1 livingroom + 2 daybeds + 1 sofa bed	2	60	4	2+1 / 2+2 / 2+3 / 3 / 3+1 / 3+2 / 4 / 4+1	1	
Lagoon Premium Suite Direct Pool Access	Premium Suite Direct Pool Access 2 Bedroom + 1 livingroom + 1 daybed	2	80	9	2+1 / 2+2 / 2+3 / 3 / 3+1 / 3+2 / 4 / 4+1	1	2
				529			

Our operation, such as meals and services, are adjusted according to the international and local rules and guidelines. Changes to hotel information, facilities, activities and services can occur for a variety of reasons. Paloma Hotels reserves the right to make changes without prior notice.

SERVICES WITH CHARGE

Spa & Wellness: Spa center, beauty care, skincare, body care, facial care, massages, and special treatments.

* Water Sports

Land Sports: Tennis courts with floodlights, tennis lessons, tennis racket & ball rentals.

Babysitter Service: Available on request for an additional charge.

Laundry and Dry-Cleaning Service: Available for an additional charge.

Doctor Service: On-call with an additional charge.

Hairdresser: Available for an additional charge.

Private Beach Cabanas: Available between 09:00 - 18:00 for an additional charge.

Reservation required through the Paloma Hotels App or Guest Relations.

All-Day Service: Orders can be made from the cabana QR menu or through the Paloma Hotels App.

***All water sports are not operated by Paloma Hotels and therefore do not form part of your holiday package. The water sports are provided by an independent operator, authorised by the local municipality and therefore Paloma Hotels cannot accept any responsibility for any loss or injury of whatever nature which may be incurred whilst partaking in these activities.**

OTHER FACILITIES & SERVICES

Shopping Area

Nurse Service

Turkish Bath and Sauna

Complimentary Wi-Fi in Rooms and Public Areas

Outdoor Car Park with Electric Vehicle Charging Station

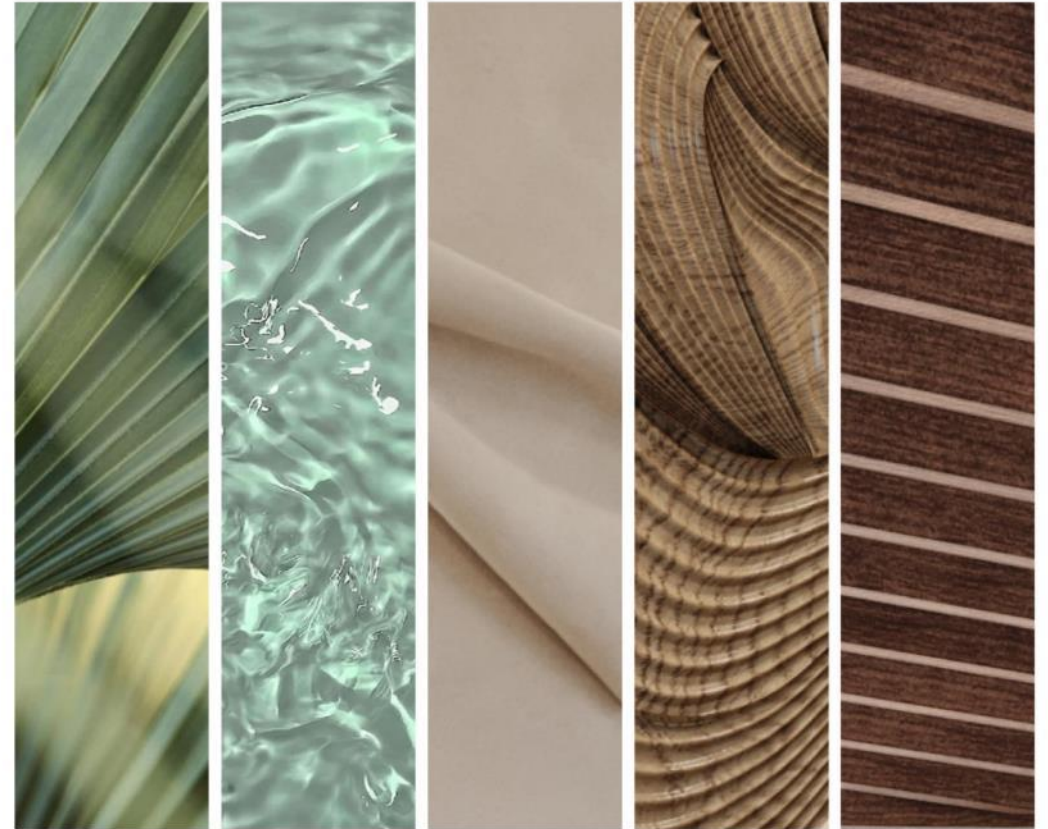

Our operation, such as meals and services, are adjusted according to the international and local rules and guidelines. Changes to hotel information, facilities, activities and services can occur for a variety of reasons. Paloma Hotels reserves the right to make changes without prior notice.

2500
M2



MEETING ROOMS & FACILITIES & EQUIPMENTS

SALON ADI	ALAN(m ²)	UZUNLUK(m)	GENİŞLİK(m)	YÜKSEKLİK(m)	STAGE(m ²)	TİYATRO DÜZENİ	SINIF DÜZENİ	KOKTEYL DÜZENİ	BANKET DÜZENİ
Ana Toplantı Salonu	500 m ²	28	17	5,3	30	600	288	315	260
Toplantı Odası 1	50 m ²	7,6	6,5	5,3		42	24	42	
Toplantı Odası 2	50 m ²	7,6	6,5	5,3		42	24	42	
Toplantı Odası 3	50 m ²	7,6	6,5	5,3		42	24	42	
Toplantı Odası 4	50 m ²	7,6	6,5	5,3		42	24	42	
Toplantı Odası 5	50 m ²	7,6	6,5	5,3		42	24	42	
Toplantı Odası 6	50 m ²	7,6	6,5	5,3		42	24	42	
Toplantı Odası 7	50 m ²	7,6	6,5	5,3		42	24	42	
Toplantı Odası 8	50 m ²	7,6	6,5	5,3		42	24	42	
Toplantı Odası 9	50 m ²	7,6	6,5	5,3		42	24	42	
Toplantı Odası 10	50 m ²	7,6	6,5	5,3		42	24	42	
NOT	Toplantı Odaları Birleştirilebilir Olarak Düşünüldü.Toplam 10 adet oda (2+2+3+3) 2 adet 100m ² ve 2 adet 150m ² olacak şekilde açılabilir.								
BİRLEŞİRİLMİŞ VERS.	100 m ²	15,2	6,5	5,3		98	48	84	

ANA BİNA TOPLANTI ODALARI PLAN

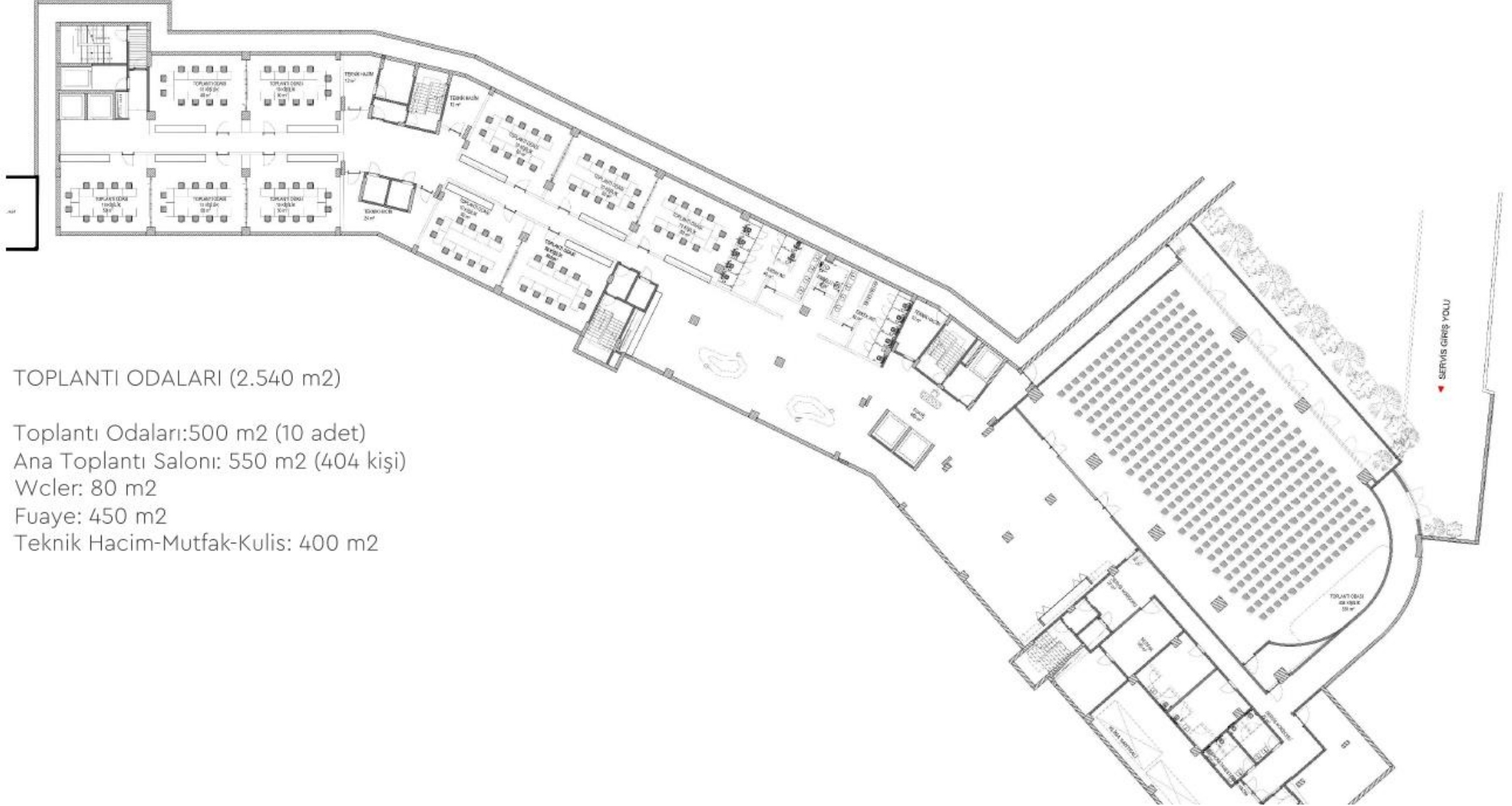

TOPLANTI ODALARI (2.540 m²)

- Toplantı Odaları: 500 m² (10 adet)
- Ana Toplantı Salonu: 550 m² (404 kişi)
- Wc'ler: 80 m²
- Fuaye: 450 m²
- Teknik Hacim-Mutfak-Kulis: 400 m²

PALOMA HOTELS

G R I D A

Fact Sheet | Summer 2025

TURKEY

- FINESSE SIDE
- PALOMA OREANDA
- PALOMA PERISSIA
- PALOMA GRIDA
- PALOMA OCEANA
- PALOMA PASHA
- PALOMA MARINA SUITES

[PALOMAHOTELS.COM](https://palomahotels.com)

 +90 850 440 00 00

  /PALOMAHOTELS